

# Wedgwood Vision Plan

January 14, 2010 Public Meeting  
Mapping Exercise Results  
**Commercial**

Mixed use and multifamily development between Lake City Way NE and 24th Ave NE



Design guidelines for new development that emphasize 'woody', community feel

Update or relocate post office

Desirable businesses:  
- Hardware store  
- Burger joint  
- Movie theater

Undesirable business area

Encourage small, locally owned businesses and discourage large chain stores

Pedestrian-scaled development

## Wedgwood VISION

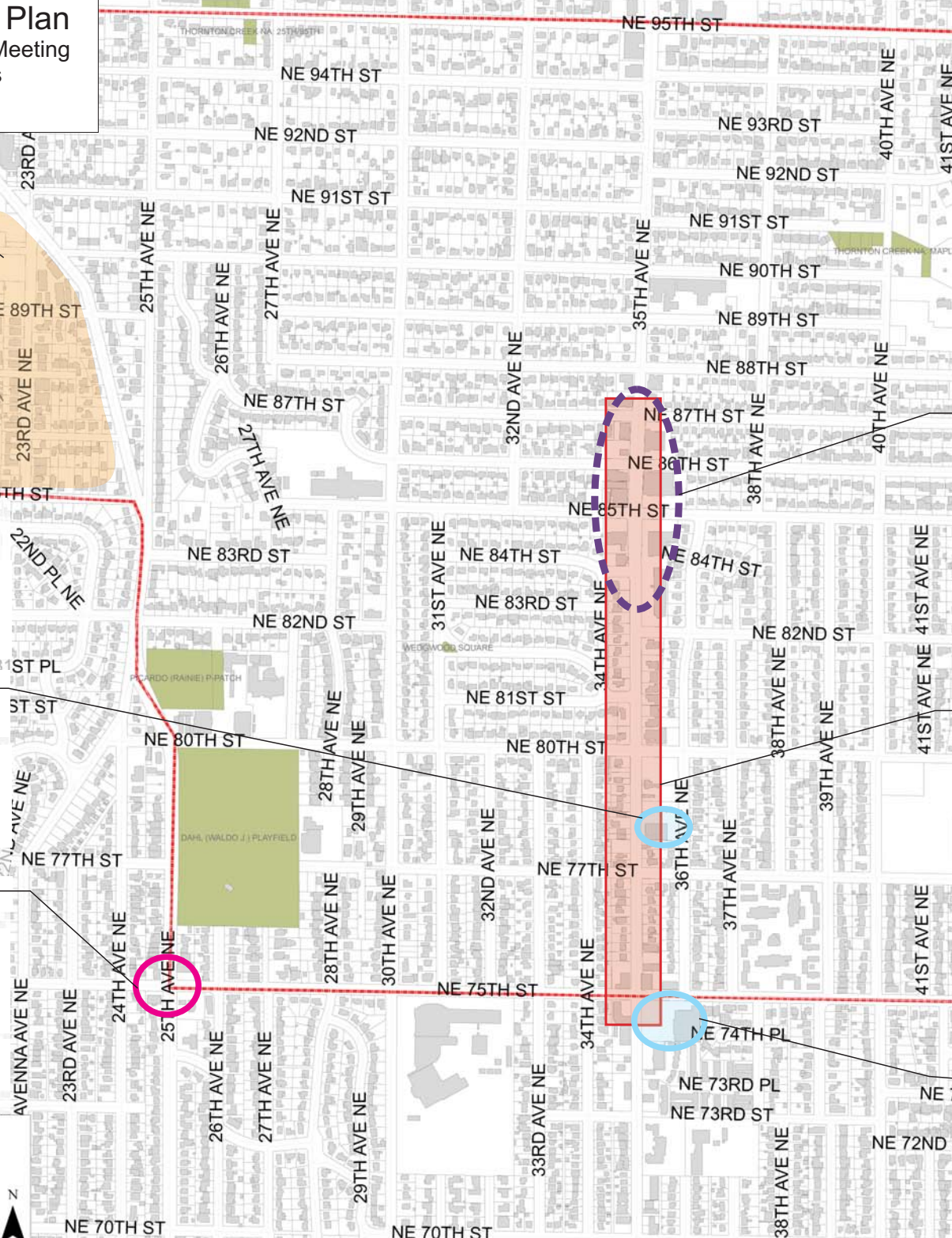
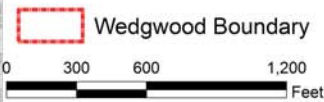

Create a node of activity - 'Downtown' Wedgwood



Allow additional density along 35th with mixed-use development (4-5 stories stepped back)



Create a continuous, walkable business district

Improve appearance of Safeway parking lot - add trees and landscaping  
If redeveloped, put parking underground or behind building